

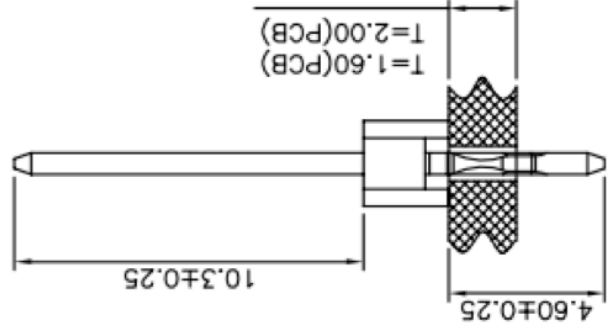

Recommended P.C.B. Layout(Top Side)  
(PCB Board Tolerance $\pm 0.05$ )

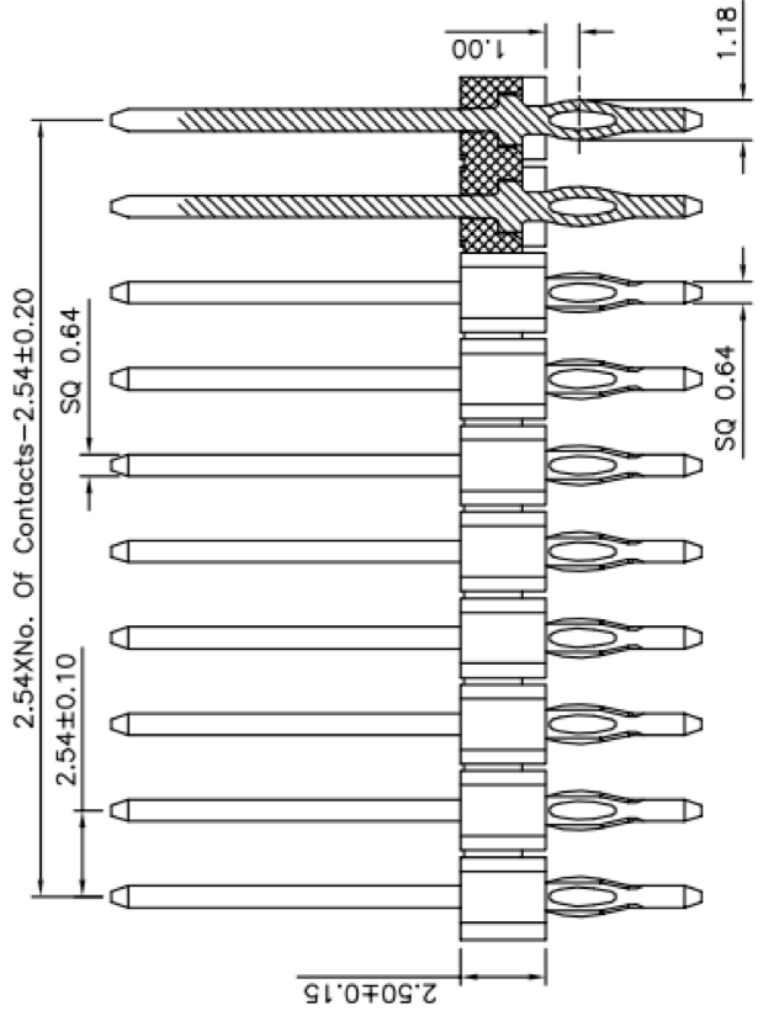
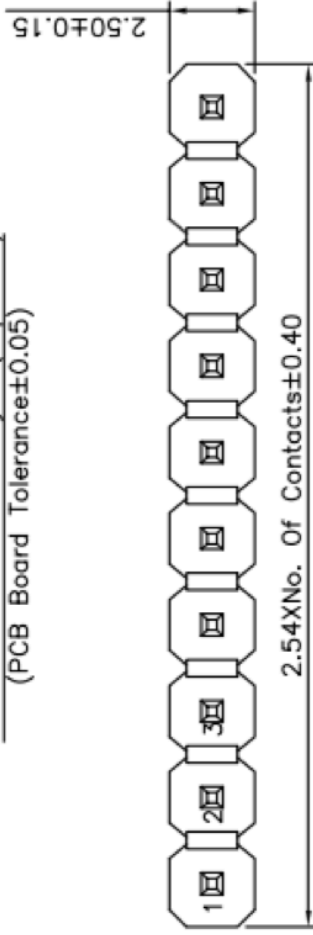

### SPECIFICATION

Current Rating:3.0 Amp  
Withstand Voltage:500V AC/DC  
Contact Resistance:20 Milliohms Max.  
Insulation Resistance:1000 Megohms Min.  
Operation Temperature: $-40^{\circ}\text{C}\sim+105^{\circ}\text{C}$   
Contact:Brass,Gold Flash On Contact Area,Tin  
Plated On Solder Tails,Over Nickel  
Insulator:PBT+30%G.F.(UL94V-0),Black  
RoHS Compliant